



Wind-sun sensor working principle

Additional Function



When breeze, the awning is on the open status



When gale, the awning begins to close up



Awning has been completely closed avoid damage by the gale



6:00 --- 8:00 AM. When the sun light is weak in the morning, the awning is on the closed state



8:00 --- 10:00 AM. When the sunlight is ample in the noon, the awning will automatically open to protect you from the sun

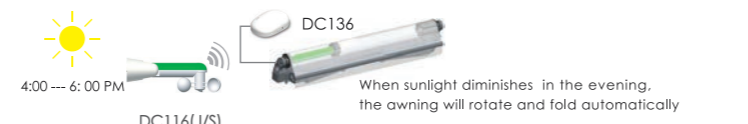

4:00 --- 6:00 PM. When sunlight diminishes in the evening, the awning will rotate and fold automatically



All controls support 433MHz & 868MHz

Control System

DC116 (J/S) Wind-sun sensor Specification

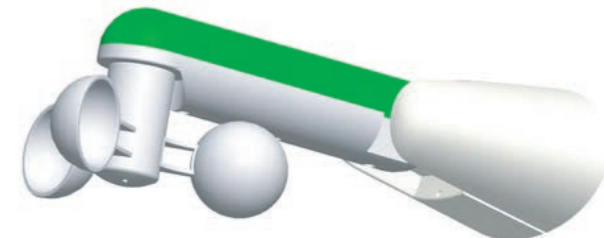

Version No. : A/04



Wind-sun sensor specification

Technical Support



- Stable performance
- Wireless
- Frequency : 433.92MHz
- Range of validity : outdoor 200 meters
- 2 screws fixed
- AC power : input 230V~50Hz
- Safety code (50 million times without repeat,high security)
- Can set three different wind scales and four different sunlight ranks
- When the wind power is more than the setting value for 3 seconds, the sensor will automatically close awning. After closed, the sensor will not the wind in one minute.
- When the light level is more than the setting value for two minutes, the sensor will automatically unfolds awning. When the light level does not reach the setting value for 15 minutes, the sensor will automatically close awning.

Note 1: Make sure to confirm that sensor has been programmed with the supporting receiver before use.

Note 2: Make sure that the upward button on the transmitter will make the awning close before use.



Wind-sun sensor grade adjusting reference

Additional Function

Wind grade reference	
0 / 1 grade	15km/h
2 grade	30km/h
3 grade	45km/h

The above grades equal to

1: When the grade is "0", "1", the wind reaches over 15Km / h, the awning will fold, LED flashing

2: When the grade is "2", the wind reaches over 30Km / h, the awning will fold,LED flashing

3: When the grade is "3", the wind reaches over 45Km / h, the awning will fold,LED flashing

Light grade reference	
0 grade	CLOSE
1 grade	15KLUX
2 grade	30KLUX
3 grade	45KLUX
4 grade	60KLUX

The above grades equal to

1: When the grade is "0", the light will close

2: When the grade is "1", the light reaches over 15 KLUX, the awning will open,LED flashing

3: When the grade is "2", the light reaches over 30 KLUX, the awning will open,LED flashing

4: When the grade is "3", the light reaches over 45 KLUX, the awning will open,LED flashing

5: When the grade is "4", the light reaches over 60 KLUX, the awning will open,LED flashing



Matchable R/E/ED Tubular Motor Set up

Additional Function

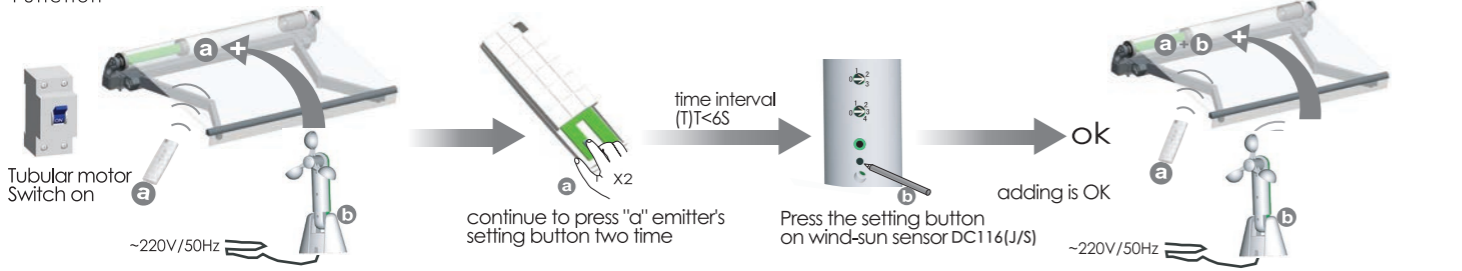

Matchable DC43 Set up

Additional Function

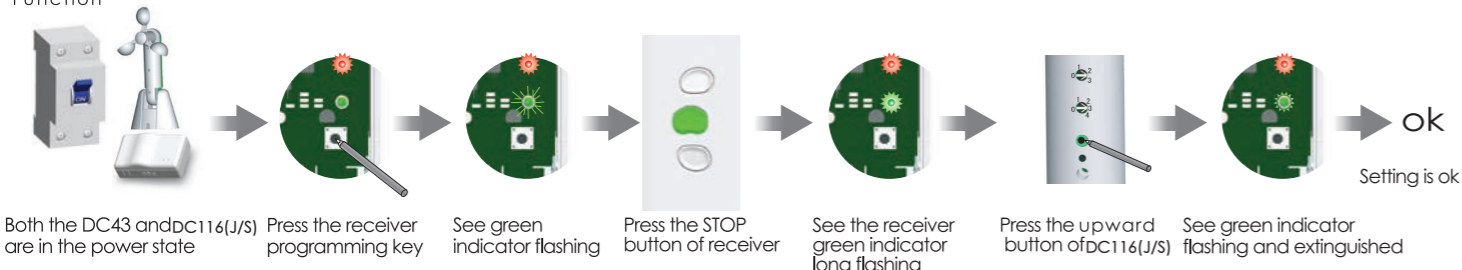

Both the DC43 and DC116(J/S) are in the power state Press the receiver programming key See green indicator flashing Press the STOP button of receiver See the receiver green indicator long flashing Press the upward button of DC116(J/S) See green indicator flashing and extinguished Setting is ok



Matchable DC136 Set up

Additional Function

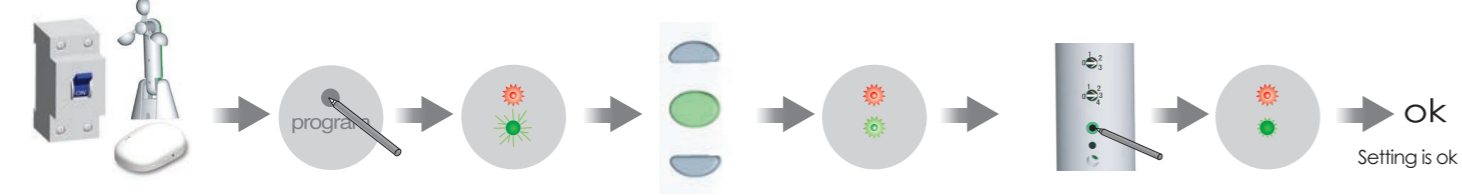

Both the DC136 and DC116(J/S) are in the power state Press the receiver programming key See green indicator flashing Press the STOP button of receiver See the receiver green indicator long flashing Press the upward button of DC116(J/S) See green indicator flashing and extinguished Setting is ok



Matchable receiver

Technical Support

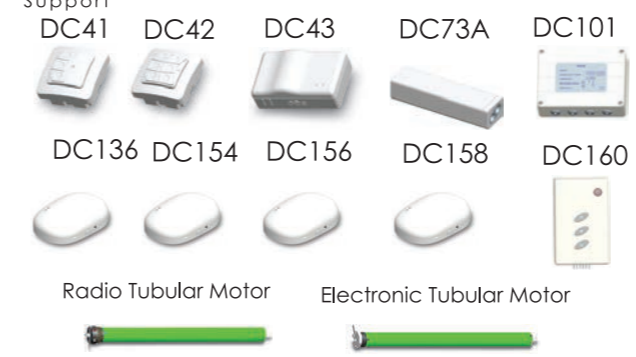

Button specification

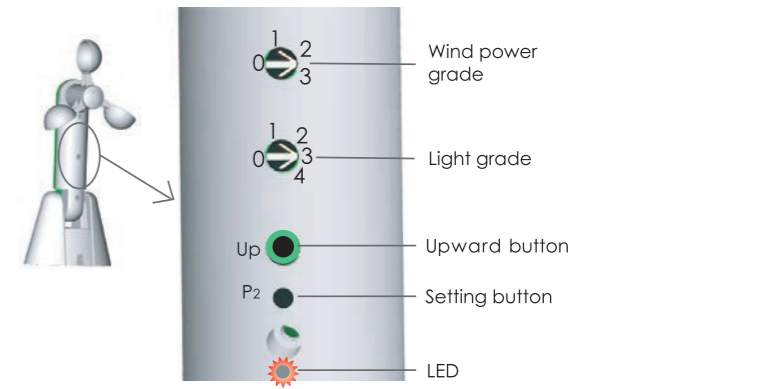

The best installation position

Technical

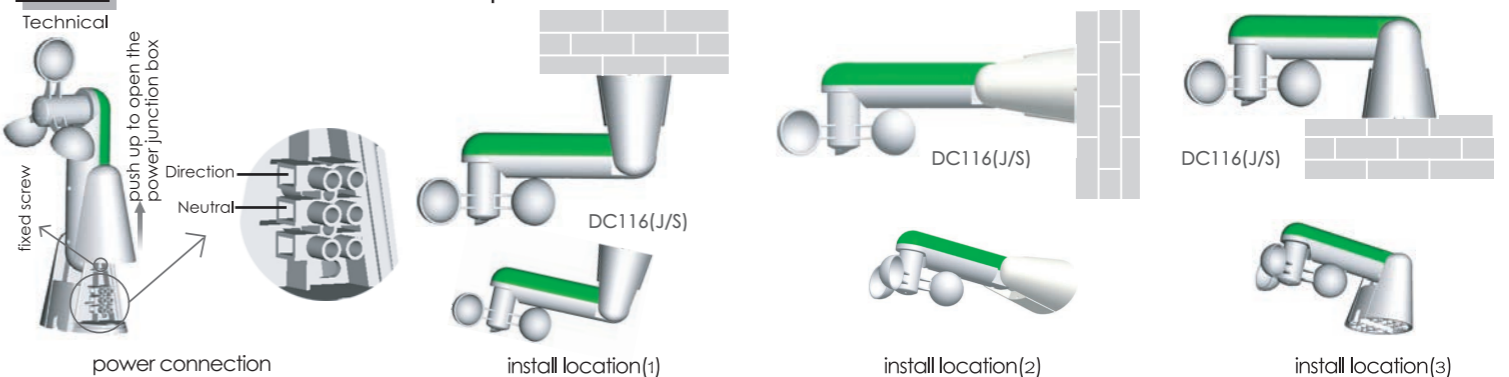

If wants to change the installation site, it needs open the power junction box,looses the fixed screw After adjusting the installation site,tighten the screws up.